

# ***SAFER Barrier***

## ***Steel And Foam Energy Reduction***

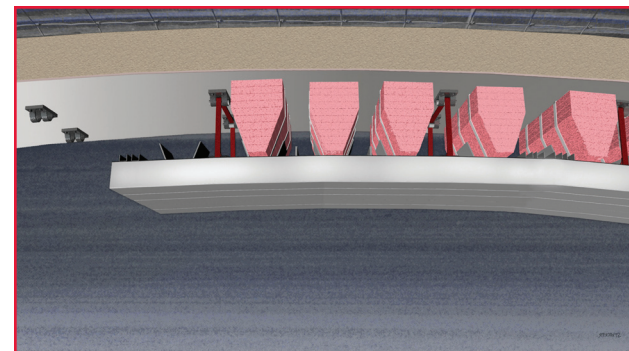

*top view*

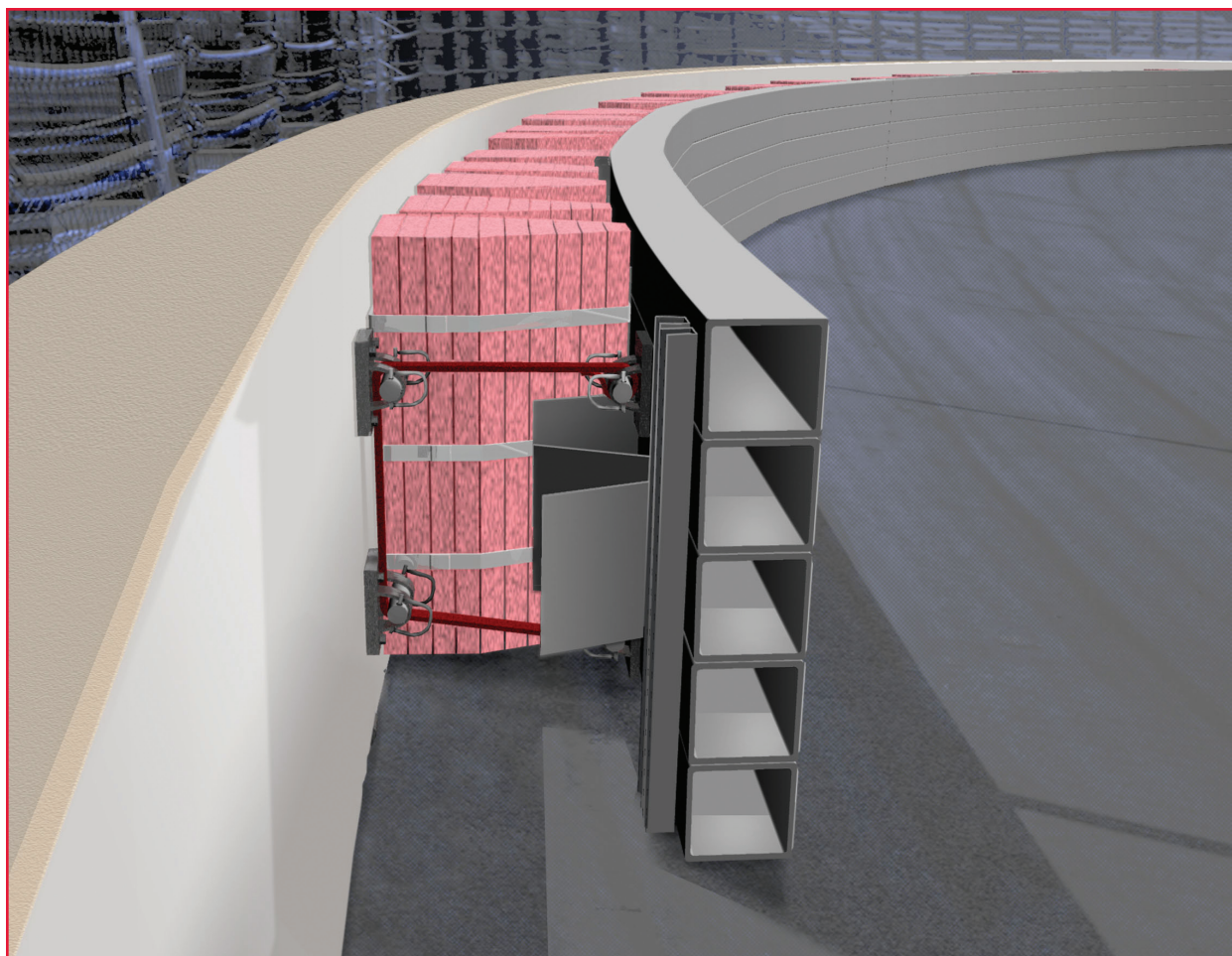

*side view*

### ***SAFER Barrier "Version 2" Key Points***

The Version 2 SAFER Barrier features these four major improvements:

- The barrier sections, which were straight in Version 1, are slightly rolled, or curved, to provide a smoother impact surface.
- A universal Styrofoam shape was created that is compatible with open-wheel cars and stock cars.
- Improved attachment points anchor the barrier to the existing concrete retaining walls.
- An increase of five steel tubes welded together form the barrier's exterior instead of four used in the Version 1 barrier.

The Speedway also permanently lengthened the SAFER Barrier by 200 feet from the entrance of Turn 1 - also Turn 13 of the road course - northward into the main straightaway to add protection for drivers competing in the United States Grand Prix Formula One race.

